

BW 12350 DC (12V35Ah)

SPECIFICATIONS

Nominal Voltage		12 V
Capacity (25°C)	20HR	35 Ah
	5HR	27 Ah
	1HR	19.2 Ah
Dimension	Length	195 ± 2mm (7.68inch)
	Width	130 ± 1mm (5.12inch)
	Height	155 ± 2mm (6.10inch)
	Total Height	166 ± 2mm (6.54inch)
Approx. Weight		10.2kg (22.44lbs) ± 5%
Terminal type		NB or M6
Internal resistance (Fully charged, 25°C)		Approx. 11m Ω
Capacity affected by temperature (20HR)	40°C	102%
	25°C	100%
	0°C	85%
	-15°C	65%
Self-discharge (25°C)	3 month	Remaining Capacity: 91%
	6 month	Remaining Capacity: 82%
	12 month	Remaining Capacity: 65%
Nominal operating temperature		25°C ± 3°C (77°F ± 5°F)
Operating temperature range	Discharge	-15°C ~ 50°C (5°F ~ 122°F)
	Charge	-10°C ~ 50°C (14°F ~ 122°F)
	Storage	-20°C ~ 50°C (-4°F ~ 122°F)
Float charging voltage(25°C)		13.50 to 13.80V Temperature compensation: -18mV/°C
Cyclic charging voltage(25°C)		14.50 to 15.00V Temperature compensation: -30mV/°C
Maximum charging current		9.3A
Maximum discharge current		310A(5 sec.)
Designed floating life(20°C)		10 years



DIMENSIONS

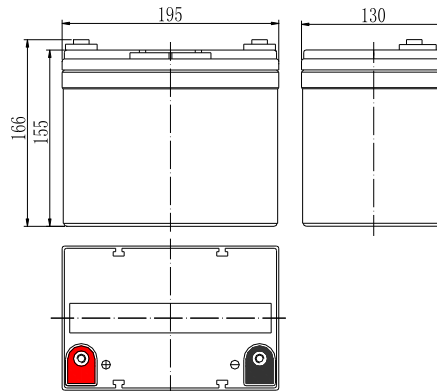

TERMINAL

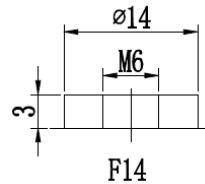

CONSTRUCTION

Component	Positive plate	Negative plate	Container	Cover	Separator	Electrolyte	Safety valve	Terminal
Raw material	Lead dioxide	Lead	ABS	ABS	AGM	Sulfuric acid	Rubber	Copper

CONSTANT CURRENT DISCHARGE CHARACTERISTICS (A, 25°C)

F.V/TIME	10min	15min	30min	60min	2h	3h	4h	5h	8h	10h	20h
9.60V	67.6	52.1	31.2	19.2	11.3	8.06	6.51	5.57	3.83	3.16	1.67
9.90V	65.6	50.8	30.5	18.9	11.3	8.02	6.48	5.53	3.80	3.15	1.67
10.2V	62.8	49.0	29.6	18.4	11.2	7.96	6.43	5.49	3.78	3.14	1.66
10.5V	60.1	47.3	28.9	18.0	11.0	7.91	6.39	5.46	3.75	3.12	1.65
10.8V	56.8	44.8	27.8	17.5	10.7	7.67	6.19	5.29	3.64	3.10	1.64

CONSTANT POWER DISCHARGE CHARACTERISTICS (WATT, 25°C)

F.V/TIME	10min	15min	30min	60min	2h	3h	4h	5h	8h	10h	20h
9.60V	730	572	350	218	131	94.8	76.6	65.8	45.5	37.7	20.1
9.90V	708	558	343	215	130	94.3	76.2	65.4	45.2	37.6	20.0
10.2V	679	538	332	210	129	93.6	75.6	64.9	44.9	37.5	20.0
10.5V	650	519	324	205	127	93.0	75.1	64.5	44.6	37.3	19.9
10.8V	613	492	312	199	124	90.2	72.8	62.6	43.2	37.0	19.7

Note: The above characteristics data can be obtained within three charge/discharge cycles.

Discharge Characteristics (25°C)

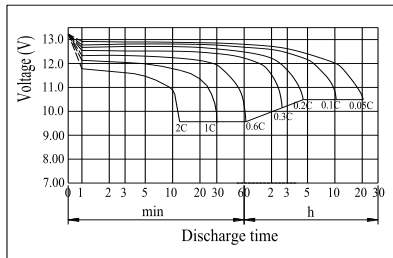

Charging Characteristics (25°C)

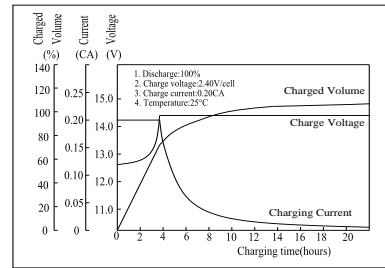

The Relationship for Open Circuit Voltage and Residual Capacity (25°C)

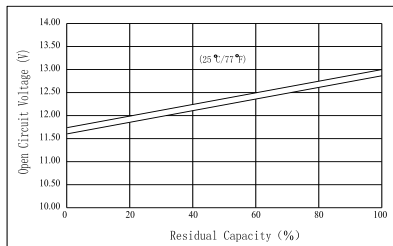

The Relationship for Charging Voltage and Temperature

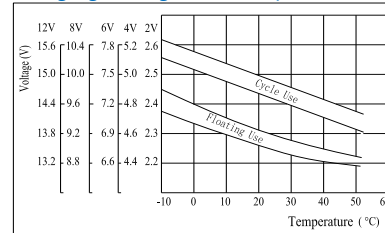

Floating Life on Temperature

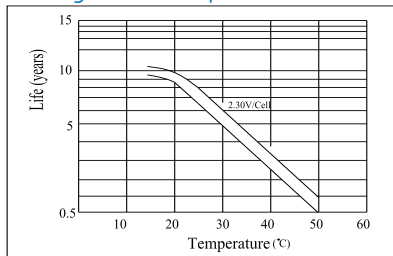

Cycle Life on D.O.D (25°C)

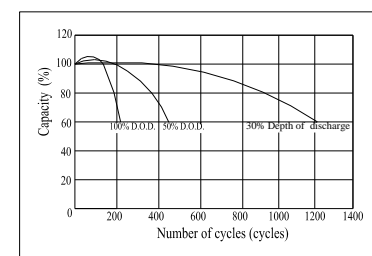

Effect of Temperature on Capacity

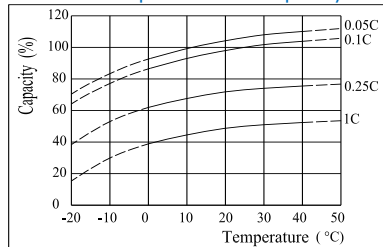

Self-discharge Characteristics

